

QUICK EXHAUST VALVE SS/6050/14

MATERIALS OF CONSTRUCTION
CF8M (SS316)
PACKINGS IN POLYURETHANIC ELASTOMER
PACKINGS IN NYLON
WORKING PRESSURE: 0,3-10 BAR
WORKING TEMPERATURE: -18°C, +70°C

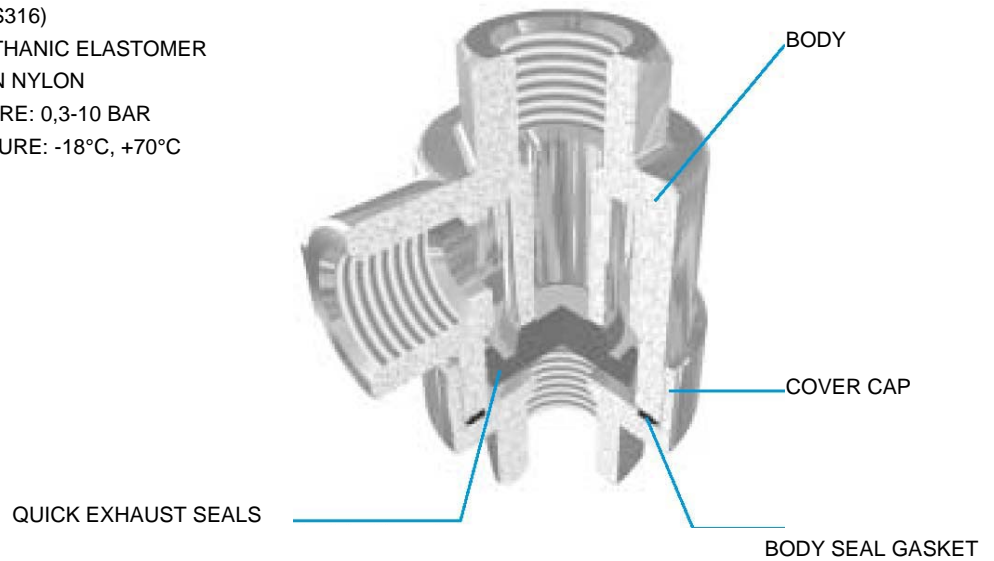

THE AIR ENTER IN THE "I" ENTRY AND, MOVING THE SEAL PACKING, IT PASSES AT THE USE "U" DIRECTLY.

WHEN THERE IS NO AIR IN "I", THE AIR IN "U" MOVES THE SEAL PACKING FOR THE PRESSURE DIFFERENCE, BY EXCLUDING "I" TO EXIT FROM THE EXHAUST "S".

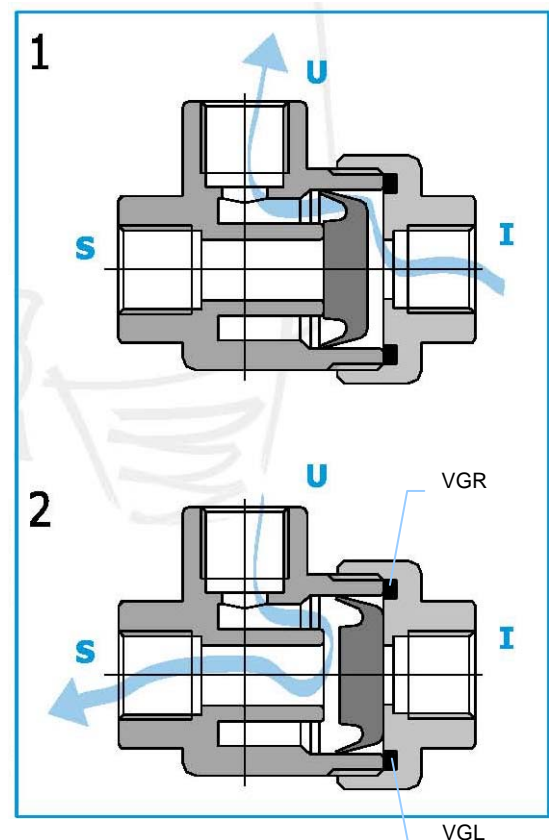

QUICK EXHAUST VALVE SS/6050/14

VSR

QUICK EXHAUST VALVE

CODE	A	B	C	D	E	F	G	CH	CH1	Gr
SS/6050/14	¼	33	53.5	34.5	25			19	19	149

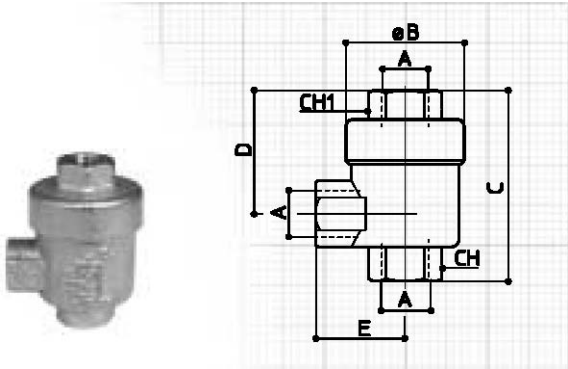

VGL

QUICK EXHAUST VALVE SEALS

CODE	A	B	C	D	E	F	G	CH	CH1	Gr
VGL004	25.5	5.8								2

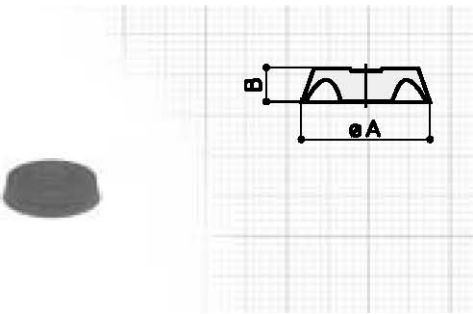

VGR

BODY SEAL GASKET

CODE	A	B	C	D	E	F	G	CH	CH1	Gr
VGR004	24	28.5	1							1

